



From My
HANDS TO
Your
Heart

Card with Flower Accent

SUPPLY LIST

- JCS112 Material Girl - Darcie's Unmounted Rubber Stamp Set
- PAC1419 Brown Marchella Darcie's Printed Card Stock - 8 1/2" x 11"
- PA1403 Mahashtra Red Darcie's Printed Card Stock 8 1/2" x 11"
- PAC1353 Malta - Darcie's Printed Paper - 8 1/2" x 11"
- PC73 Chocolate Card Stock
- PC55 Bright White Card Stock
- I-Top Brad Maker
- I-top small brad daddies
- I-top punches - all 3 sizes
- EZC5 Darcie's EZ Cutts Cutting Template - Aidan
- EZC4 Darcie's EZ Cutts Cutting Template - Raine
- Swivel Knife and White Cushion cutting mat
- Ranger Inkssentials Glossy Accents
- Ranger Inkssentials Ink Blending Tool
- Tim Holtz Distress Inks - Worn Lipstick, Frayed Burlap
- Ranger Perfect Pearls - Perfect Gold
- Ink Pads - Dark Brown, Lime, Blue, Dark Pink, Red

© 2010 Copyright Darcie Heater, Darcie's, LLC. All rights reserved. For personal use only, may not be reproduced.

FLOWER INSTRUCTIONS

1. The punches used to make the different sizes of I-top brads can also be used to make flowers. Punch one of each of the three sizes out of Darcie's Printed Card Stock, and punch a center for the flower out of a coordinating paper.



2. Remove one petal on each of the flower shapes by cutting to the center of the flower in a triangular shape, as shown below.



3. Place the cutouts on a non-stick craft mat. Using a Ranger Inkssentials Ink Blending Tool, apply Worn Lipstick Distress Ink to the edges of the flowers. Using a circular motion when applying, start with the Blending Tool on the mat, swirl the tool on the mat, then begin swirling color onto the edges of the cutouts.



4. Repeat Step 3, for the back of each cutout.



5. Repeat Steps 3 and 4, using Frayed Burlap Distress Ink.



6. Using the Frayed Burlap Distress Ink, repeat Step 3 for the flower center.



7. Apply a small amount of Ranger's Inkssentials Glossy Accents to the edge of the cutout area of each flower petal, as shown below.



8. Overlap the petals in the cutout area as shown below, and press into place until the glue dries (about a minute).



9. Repeat for all 3 flower petal layers.



10. Using a stylus, curl the ends of each petal under.



11. Repeat for the petals on all 3 flower layers.



12. Make the flower center brad using the I-top tool. The I-top tool comes with complete instructions... and an instructional DVD.



13. Punch a 1/8" hole in the center of the smallest flower layer. (We used the Crop-a-dile to punch the hole.)



14. Attach the brad through the hole punched in the smallest flower layer.

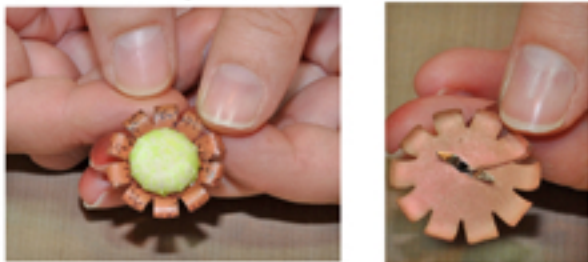

15. Apply Glossy Accents to the inside center of the largest flower layer. 16. Press the medium size flower layer onto the glue and hold in place until the glue dries, about a minute.



16. Apply glue to the center of the flower layers, and attach the smallest layer with the brad. Hold in place until the glue dries.



17. Mix water and Perfect Pearls - Perfect Gold in a Ranger Mini Mister. Shake well and spritz the completed flower.



CARD ASSEMBLY INSTRUCTIONS

1. Cut the following items:

- From the Chocolate Card Stock, cut a 5" x 10" rectangle. Score in half and fold to make a 5" x 5" card.
- Use Darcie's Raine Cutting Template to cut a shape out of the Mahashtra Red card stock.
- Use Darcie's Aidan cutting Template to cut a shape out of the Bright White Card Stock.

2. Stitch around the edges of the front of the card, if desired.

3. Stamp the "From My Hands...to your" portion of the saying onto the Bright White Card Stock Aidan shape. Stamp the following items onto scraps of the Bright White Card Stock: Brown Ink - Mannequin, Red Ink - Flourishes. Stamp the HEART portion of the saying four different times using the following inks (stamp on the Bright White Card Stock): Lime, Red, Blue and Dark Pink. From the Lime inked image cut out the H and the T. From the Blue image, cut out the E. From the Red, cut out the A, and from the Dark Pink cut out the R.

4. Use the Ink Applicator Tool and Frayed Burlap Distress Ink to grunge the edges of the shapes, sayings, letters and cutout images.

5. On the Aidan Bright White Shape, layer the HEART letters below the "From my Hands" portion of the lettering, using double sided foam tape. Position the letters as shown in the photo on Page 1.

6. Attach the Mahashtra Red Raine shape onto the Chocolate Card Stock card front, using permanent adhesive.

7. Attach the Bright White Aidan shape onto the front of the card, centering it on the Raine shape, using double sided foam mounting tape.

8. Attach the mannequin, the flourishes, and the flowers using double sided foam tape.

9. Add any desired embellishments. We used adhesive rhinestones on the flower centers.